



## **Elko-NV-036-042-008 (2.06 Ac)**

### Property Details:

- APN: 036-042-008
- NEAREST CITY: Elko, NV 89801 (5.7 miles, 15 minutes)
- LEGAL DESCRIPTION: Lot 8, Block 42, Meadow Valley Ranchos Unit 4
- TAXES: Approximately \$20.46 per year
- HOA: None
- ACCESS: Dirt Road, Drum St (18<sup>th</sup> St) , maintained by the County
- ZONING: AR (Agricultural Residential)
- PROPERTY USE CODE: 120 – Vacant – Single Family Residential
- POWER: Contact Wells Rural Electric Co. (775) 664-2204. Solar or wind or generator are options.
- WATER: Needs well or tank. Contact Nevada Division of Water Resources
- SEPTIC: Needs to be installed. Contact Nevada Division of Health
- GAS: Need to use propane. Contact Propane of Wendover, Inc. (775) 664-2291, or Wells Propane, Inc. (775) 752-3421
- WASTE: Need to contact Elko Sanitation
- Camping: Allowed 28 days at a time
- RV: Allowed, but if not hooked up to a septic system they have to be moved every 28 days
- Mobile Homes: Allowed but a building permit is required. Must have an approved septic permit and well access.
- Property Address: Drum St.
- Property City: Elko
- Subdivision: Meadow Valley Ranchos 4
- Lot Number: 8
- Block Number: 42
- Terrain: Sloped, Desert, Plain
- Area Attractions: Northeastern Nevada Museum, Peace Park, California Trail Interpretive Center, Lamoille Canyon Scenic Byway, Western Folklife Center,

Wild Horse State Recreation Area, Main City Park, South Fork State Recreation Area

- Elevation: 5212 ft (low) 5236 (high)
- Zip Code: 89801
- Acreage: 2.06

GPS Coordinates:

- ESTIMATED GPS CENTER: 40°53'36.37"N, 115°43'28.17"W
- ESTIMATED NW GPS : 40°53'37.84"N, 115°43'30.10"W
- ESTIMATED NE GPS: 40°53'37.85"N, 115°43'26.21"W
- ESTIMATED SE GPS: 40°53'34.90"N, 115°43'26.23"W
- ESTIMATED SW GPS: 40°53'34.90"N, 115°43'30.11"W

GOOGLE MAP DIRECTIONS: <https://goo.gl/maps/jeJpp8HaSLT9386U8>

For land use information call Planning & Zoning: (775) 777-7160

County Website: <https://www.elkocountynv.net/>

GIS PHOTO VIEW

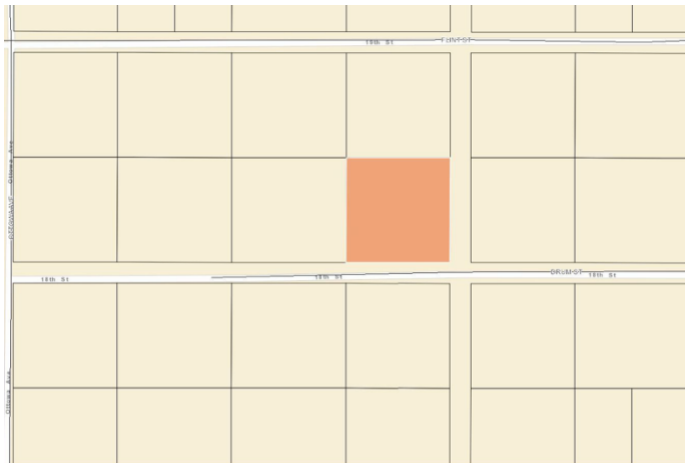

AERIAL PHOTO VIEW



STREET LEVEL VIEW

